



Quick Reference Guide

PMD-B100



■ Installing the Battery

Before using Blackbird, install the included rechargeable battery. It is recommended that the battery be charged using the supplied AC adapter for 8 hours before using the system.

⚠ WARNING

Always turn off power to the system before installing or removing the battery. Failure to do so will result in damage to your system.

- 1 Place Blackbird face down on a flat surface.
- 2 Press the battery door and pull away from the main unit body.
- 3 Attach the battery to the battery door will be a click sound-heard.
- 4 Insert and slide the battery assembly back into the main unit until a click sound is heard.

Note: Avoid removing this battery from the main unit. If the battery needs to be replaced, dispose of it in accordance with local hazardous material requirements.

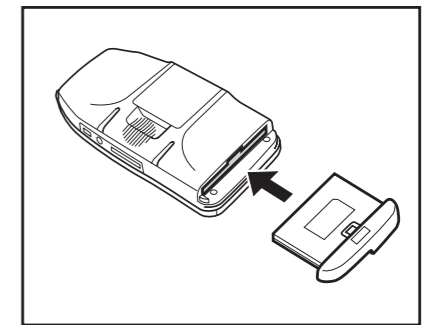
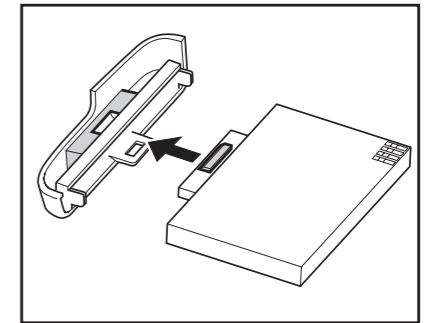

■ In the Box

Power Button- Press and hold for 2 seconds to power on the unit.

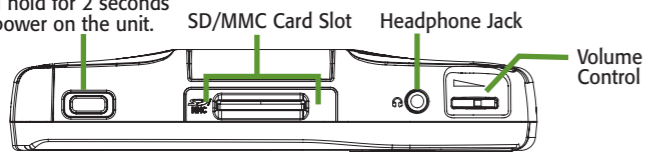

SD/MMC Card Slot Headphone Jack

Volume Control

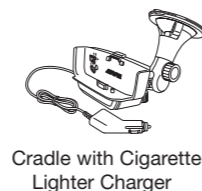

Cradle with Cigarette Lighter Charger



AC Adapter



Remote Sensor and Ambient Light Sensor

Map Zoom In

Main Menu

Music

Destination

Map Zoom Out

Current Vehicle Position Icon

Battery Charging Status Indicator



USB Cable

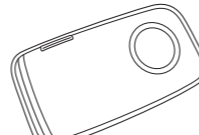

Carrying Case



Wiping Cloth



1200mAh Battery

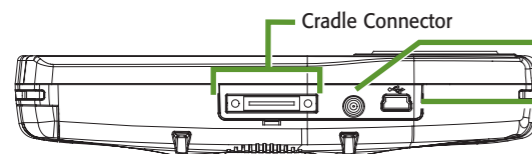

Cradle Connector

External GPS Antenna Connector

Mini USB Connector



Owner's Manual



Quick Reference Guide

■ How to Mount Blackbird

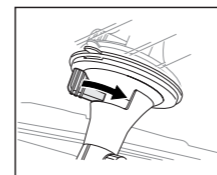

- 1 Find a spot suitable for the navigation system. Ensure that both the suction cup and windshield area are clean and free of dirt and grease before attaching it. Stick the suction cup mount against the windshield. Turn the knob to activate the vacuum to lock the position.

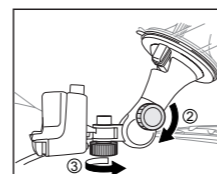

- 2 Turn the knob counterclockwise to adjust up/down position. Then turn clockwise to set the position.

- 3 Turn the knob clockwise to adjust right/left position. Then turn counter clockwise to set the position.

DEVICE SHOULD NOT BE INSTALLED SO THAT IT OBSTRUCTS THE DRIVER'S VIEW.

- 4 Open the antenna before inserting the navigation system into the cradle. For best reception sensitivity, position the antenna 90 degrees to the main unit.

⚠ CAUTION

Remove the navigation system when you are away from the vehicle to prevent theft.

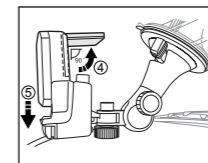

- 5 Slide the navigation system into the cradle until you hear a click sound.
- 6 Plug the cigarette lighter charger into the cigarette lighter socket.

■ To Remove the Navigation System from the Cradle

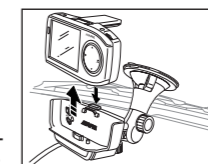

- 1 Press and hold the eject button on the cradle.
- 2 Grasp the navigation system behind the antenna and remove by sliding up and out of the cradle.

⚠ WARNING

Improper installation may make the navigation system fall out from the cradle while driving. Please make sure all locks and knobs are turned tight. Do not install the navigation while driving.

Note to California consumers: California Vehicle Code 26708 prohibits the placement of any object on windows. Refer to your authorized Alpine dealer for other installation options.

Map Functions

Below is an overview of different buttons and icons on the map display. For more detailed information about this screen, please see the owner's manual.

Next Street Name
Next Maneuver Arrow
Distance to next maneuver
Distance to Destination
Map Orientation
Current Street Name
Current Vehicle Position – press this icon to return to the map from any screen. Also switches between MAP and ARROW screens.
Main Menu – press this icon to access the main menu
Battery Status Indicator
GPS Status bar
Map Scale Bar
Voice Prompt Repeat Button – Repeats the last voice prompt command.
Return Key – Cancels back one screen.

Main Menu

From the Map or any screen, touch the Main Menu to access the following menus:

Destination
Set and save destinations using any of six different input methods.

Entertainment
Select and play MP3 music stored on your SD or MMC card.

Home
Easily get back to a pre-determined home location from anywhere you're located.

Route
Allows you to view maneuver lists, re-route or take a detour route, changing routing methods, or stop turn-by-turn guidance.

Information
Contains system information as well as a navigation demonstration function.

Edit
Edit Home destination, Address Book, and Previous Destinations.

Traffic
The traffic button is a feature coming soon that will allow you to take advantage of the built-in traffic information receiver. Optional subscription service required.

Setup
Allows you to customize various characteristics of your navigation system's look and feel.

Go to a Destination

The following example briefly describes how to input a destination in the Blackbird Portable Navigation System.

- Select **Destination** from **Main Menu**. Or press Destination button.
- Select desired method. (**Places** and **By Places** Type is selected.)
- Scroll the list. Select desired place type. (In this example, **AMUSEMENT PARKS** is selected.)
- Select the search method. (In this example, **Sort by Name** is selected.)
- Start typing in the first few letters of the name of the place. After a while a match may appear. Select it.
- Select **OK to Proceed** to set the destination. Map is displayed. Follow the navigation.

Play Music

Audio
GO AND PLAY
ALPINE BAND
1/1 **2/3** **0'14"**
PLAY **VOL. 15**

Displays Song Titles and Artist Names
 Playing Time
 Folder Number
 File Number
 Back
 Play/Pause
 Forward
 Folder Up
 Folder Down
 Folder Search
 REPEAT
 M.I.X.

- Go to **Main Menu** → **Entertainment**.
- Select a folder by using **Folder Search**.
- Select a song by using **Back** or **Forward**.
- Touch **Play**.